

SYSG5010 Point Type Leak Detection Sensor Product Information



- 12-24 VDC/AC power supply
- Stainless steel detection probe
- Sensitivity adjustment function
- Relay output remote alarm control

Easy to set up and use

- The leak detection sensor is an integrally designed water leak alarm device. The connecting cable and sensing cable are all easy to install and internally adjustable. you just need to adjust the sensing height of the sensing cable.
- The sensor can be installed and used independently or used as a sensing cable with other water leak detection units. It can also be integrated with various monitoring systems.
- Remote alarms and remote device control can be realized thanks to the output relay contact signals. The module circuitry adopts a highly sensitive detection principle and is designed with a unique surge protection function, which not only ensures high sensitivity during detection, but also prevents false alarms caused by various external factors.

Multi-purpose design

- Can be used in all kinds of environments with its completely sealed and waterproof structure.
- Detection sensitivity can be adjusted to respond widely to different levels.
- Easy to use and long-lasting with its height-adjustable stainless steel sensing probe.
- Wide voltage power supply, 12-24VDC/AC power input
- Alarms can be easily understood thanks to the alarm indicator and buzzer.

Teknik Detaylar

Detection Probe	3.2mm radius "L" shaped stainless-steel cable
Detection Sensitivity	0-10K adjustable, response time less than 1 second (at the highest sensitivity)
Measurement level (height)	0-10mm adjustable height
Plastic Body	Black ABS, IP65 waterproof material
Power	12-24VDC/AC (no polarity connection)
Environmental Conditions	Temperature: -10 to 50 degrees Celsius; Humidity: 5% to 90% (non-condensing)
Dimensions	65x60x35mm – 100g
Relay Output	1 SPDT, 60VDC ya da 220VAC/2A
Terminals	Power Input: Black Red: Power (no matter positive or negative) Output signal: Blue: NC, Yellow:COM, Green: NO



Point Type Leak Detection Sensor Installation

Caution:

** Please carefully confirm the power supply voltage before turning on the power and make sure the power cord is connected to the correct port, otherwise it may cause malfunction of the sensing module.

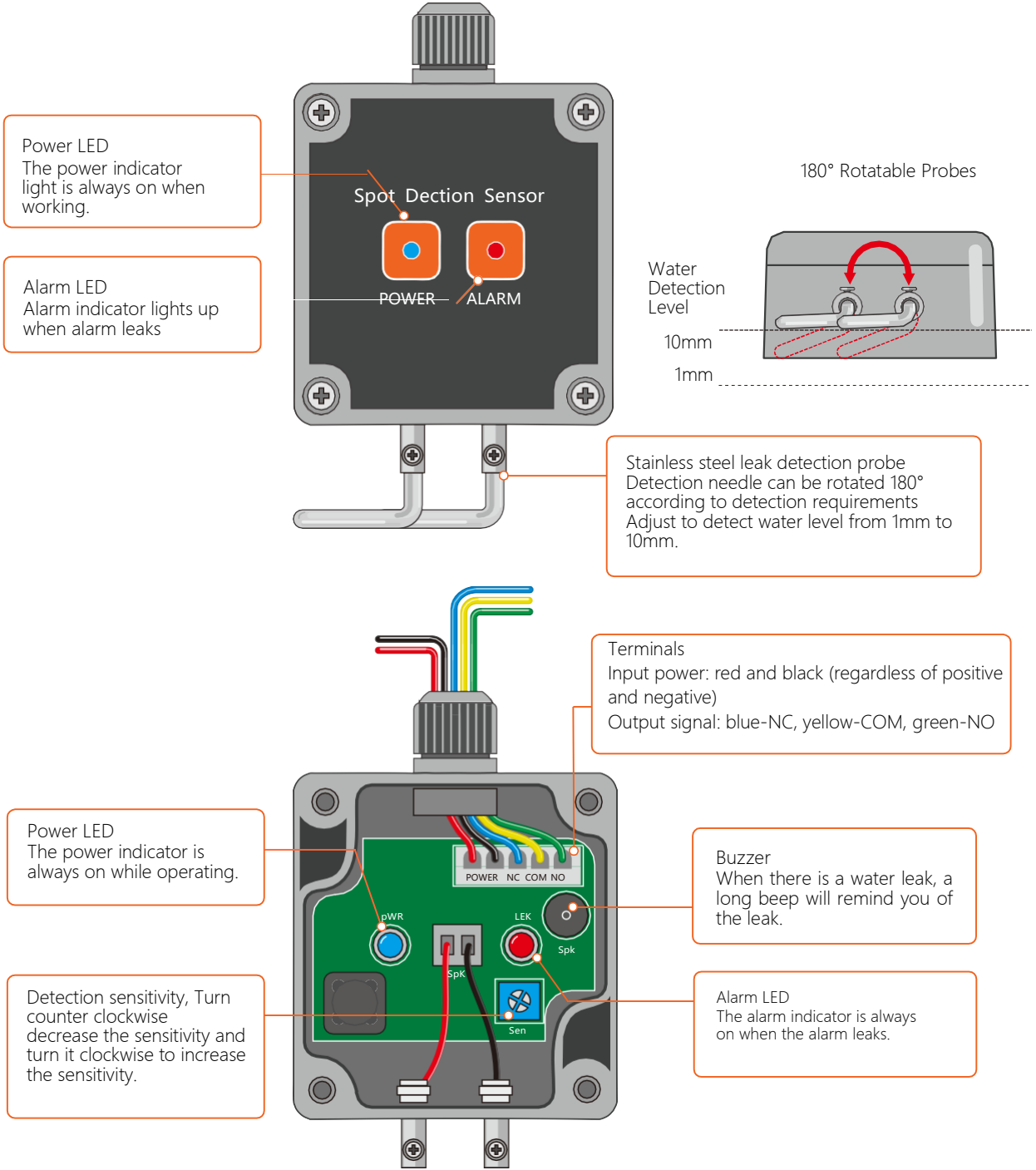

PRODUCT SKU	BARCODE	P/N	DESCRIPTION
SYSG5010	8699931601350	7270SE92011	Point Type Leak Detection Sensor

LIMITED PRODUCT WARRANTY

All ExaGate products are covered with 2 years limited guarantee from the date of original purchase. (Warranty duration may change depending on your country) Your sales or delivery receipt, showing the date of purchase of product is your proof of purchase. ExaGate is obliged to repair or replace the defective hardware (or any part of it's) with no charge to owner.

Conditions Void of Warranty

- Damages on unit, cable or screen.
- Defections due to electrical wiring and/or city network.
- Interference to unit by non-authorized staff.
- Any problems caused by act of nature.
- Misusage of unit stated by the user manual.
- Removal or destruction of serial number, warranty labels.
- Any kind of modifications on unit.