



Gigabit SFP Optical Module

Plug-in Mounting

Industrial Single/Multi-Mode Single/Double Fiber Gigabit SFP Optical Module

- Transmission speed 1.25Gb/s
- Support LC optical fiber connector and hot-plug
- Support Digital Diagnosis Monitoring (DDM) function, conform to SFF-8472 standard, which can monitor parameters such as module voltage, temperature, bias current and optical power
- Work voltage 3.3V
- Support -40~85°C wide operating temperature range



Industrial Grade



Introduction

This series of products is industrial Gigabit SFP optical module, which implements photoelectric conversion in optical network and is used with Gigabit SFP slot of Ethernet communication device. Optical module supports DDM (digital diagnosis and monitoring) function, and can monitor module voltage, temperature, bias current or optical power and other parameters in network management devices with DDM function for network diagnosis. This series of products can be selected according to different optical fiber types, transmission distances and transmission wavelengths, and can support hot plug and meet the needs of different application sites.

Dimension

Unit: mm

- Single-mode single-fiber

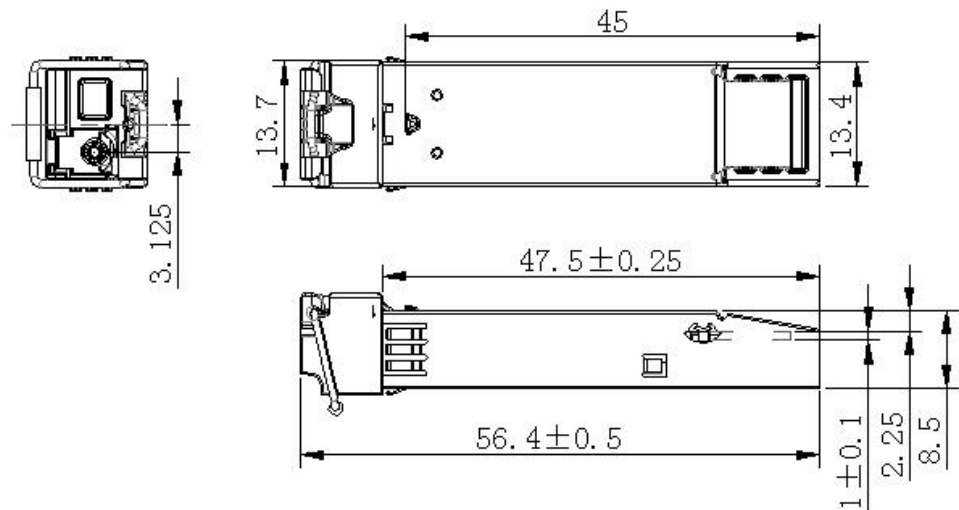

- Single/multi-mode double-fiber

Ordering Information

Available Models	Optical Fiber Type	Transmission Speed	Interface Type	Core Wavelength (nm)	Transmission Distance (km)	Work Temperature (°C)	DDM	Tx Optical Power (dBm)	Max Receiving Sensitivity (dBm)
SW2825DI-142-N	MM	1.25G	LC	1310	2	-40~85	√	-9~-3	-20
SW3825DI-442-N	SM	1.25G	LC	1310	20	-40~85	√	-6~-1	-21
SW3825DI-542-N	SM	1.25G	LC	1310	40	-40~85	√	-2~-3	-24
SW4825DI-742-N	SM	1.25G	LC	1550	80	-40~85	√	-3~-2	-26
SWB3825DI-442-N	SS	1.25G	LC	1310T/1550R	20	-40~85	√	-9~-1	-23
SWB4825DI-442-N	SS	1.25G	LC	1550T/1310R	20	-40~85	√	-9~-1	-23
SWB5825DI-542-N	SS	1.25G	LC	1490T/1550R	40	-40~85	√	-7~-1	-24
SWB4825DI-542-N	SS	1.25G	LC	1550T/1490R	40	-40~85	√	-7~-1	-24
SWB5825DI-642-N	SS	1.25G	LC	1490T/1550R	60	-40~85	√	-5~0	-24
SWB4825DI-642-N	SS	1.25G	LC	1550T/1490R	60	-40~85	√	-5~0	-24
SWB5825DI-742-N	SS	1.25G	LC	1490T/1550R	80	-40~85	√	-3~-2	-26
SWB4825DI-742-N	SS	1.25G	LC	1550T/1490R	80	-40~85	√	-3~-2	-26

Note:

- Type of optical fiber: MM is multi-mode double-fiber, SM is single-mode double-fiber and SS is single-mode single -fiber.
- Generally, optical modules should be used in pairs, and the type, speed, wavelength and distance of optical fibers should match. The transmission and receiving wavelengths of single-mode single-fiber are different, for example, 1310T/1550R and 1550T/1310R need to be used in pairs.