

KOM-RH

14*slots Rack-mounted fiber optic transceiver chassis



» Overview

The KOM-RH rack-mounted fiber optic transceiver chassis is specifically designed for KOM600H fiber optic transceiver modules, supporting up to 14 hot-swappable KOM600H modules. The KOM-RH supports dual powers redundancy with input voltage options of 100-240VAC/110-220VDC, housed in a metal enclosure with an IP40 protection class. It has an extreme environmental temperature adaptability range from -40°C to +70°C and excellent EMC (Electromagnetic Compatibility) performance. These features ensure the stable and reliable operation of this product series in harsh industrial environments, making it suitable for a wide range of applications in industries such as power, transportation, and oil and gas.

» Key Features

- Supports 14 slots, hot-swappable
- Dual power redundancy with 100-240VAC/110-220VDC Maximum power consumption is less than 45W
- Operating temperature range from -40°C to +70°C
- Meets industrial level 3 electromagnetic compatibility requirements IP40 protection class
- 19-inch rack mountable design

» Product Specifications

» Mechanical Drawing

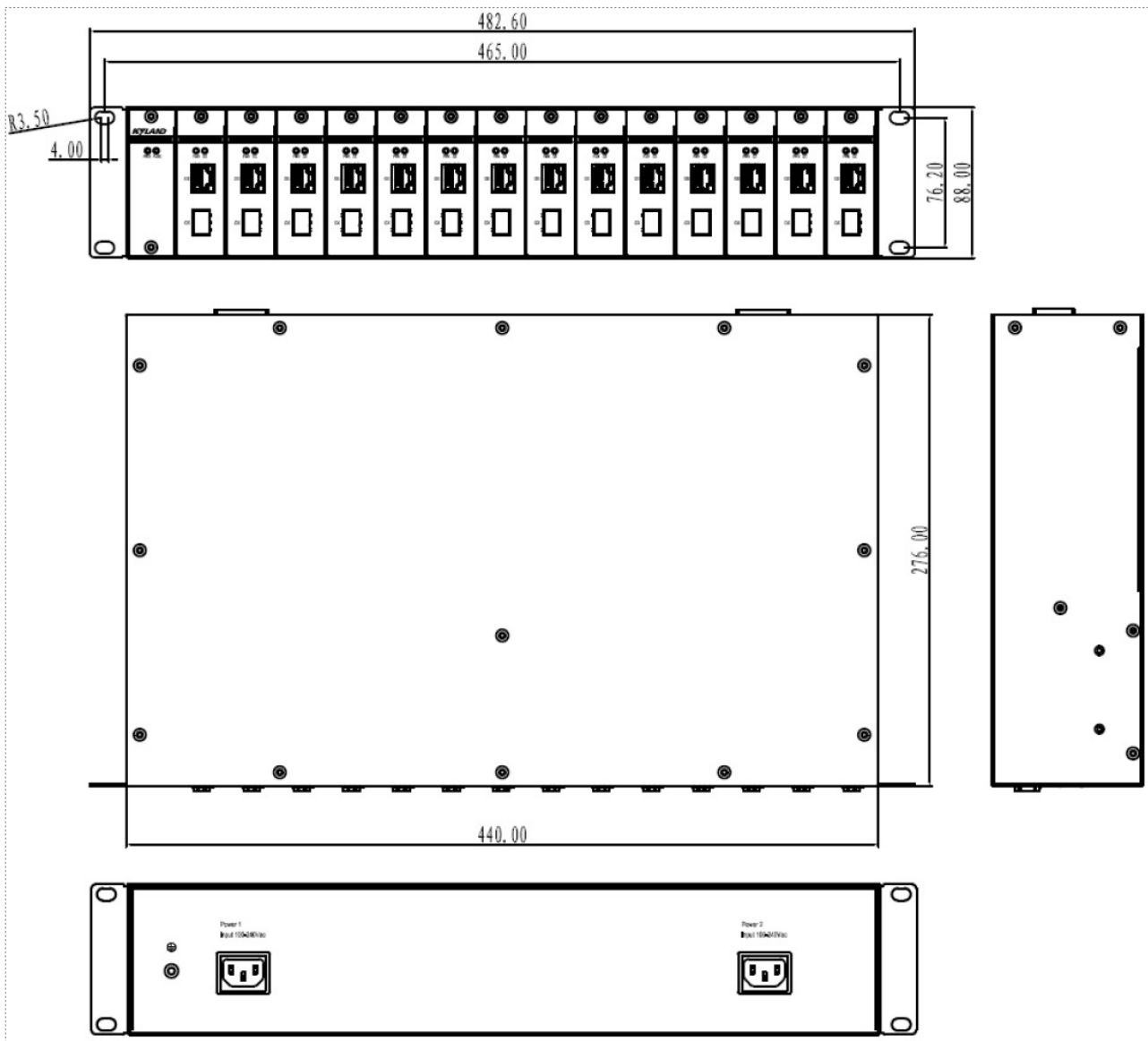

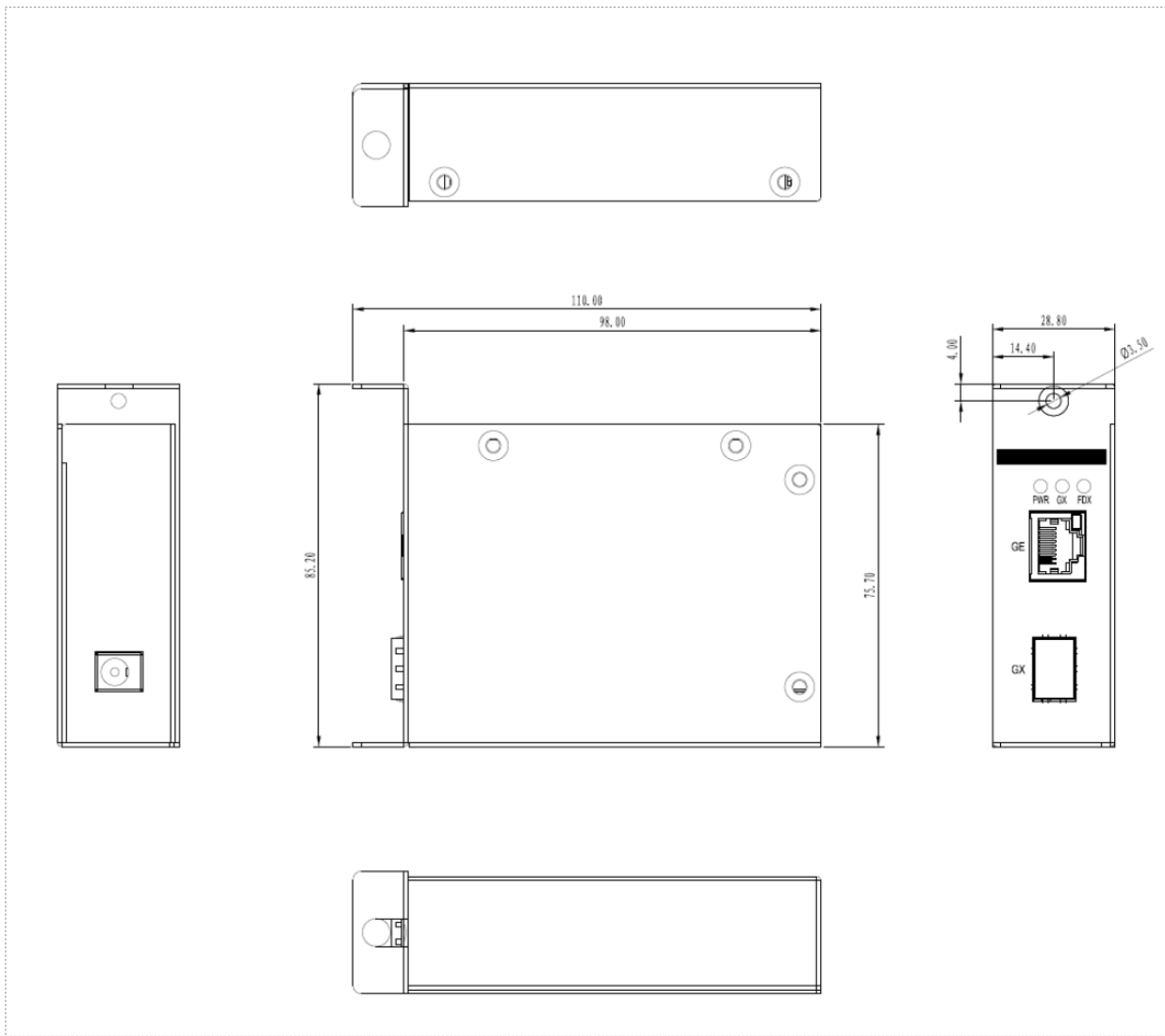

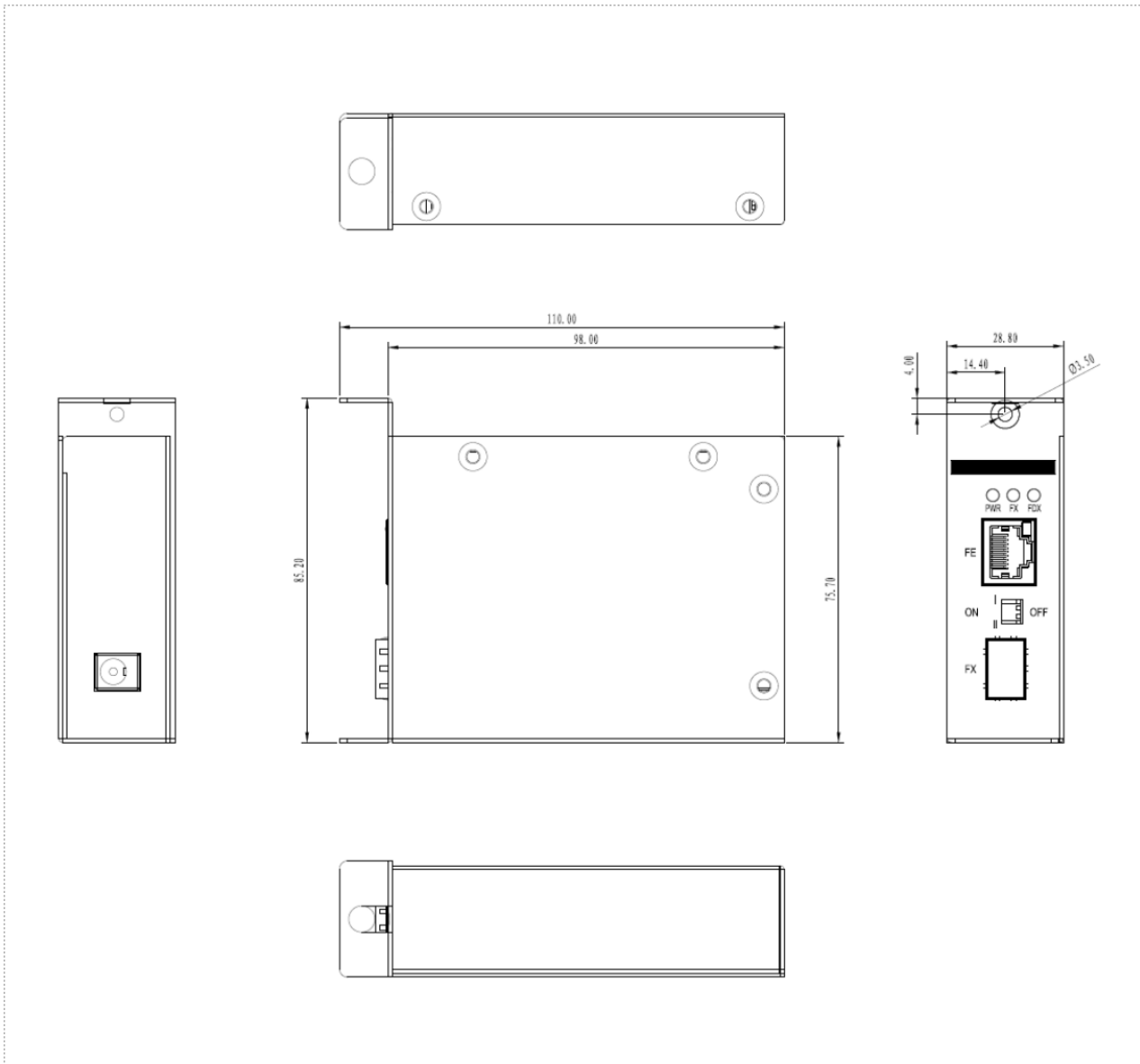

Ordering Information

Recommended model

Product Type	Port slots	Power Supply			
KOM-RH	14	100-240VAC, 110-220VDC, Dual Redundancy Powers			
Product Type	Fiber port (1000M SFP)	RJ45 port (10/100/1000M RJ45)	Fiber port (100M SFP)	RJ45 port (10/100M RJ45)	Power Supply
KOM600H-1GX1GE-12VDC1		1			12VDC, one single
KOM600H-1SFP1T-12VDC			1	1	12VDC, one single

Accessories

Accessories Type	Description
SFP Module	See the selection table of industrial SFP module
DT-FCZ-RJ45-01	Single-port RJ45 dust plug

